

# Truss Technology IN BUILDING

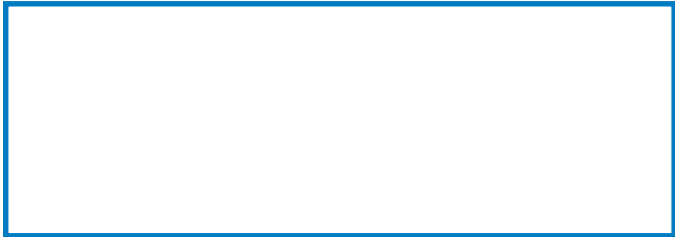

## Construction Loading

The term **construction loading** is used to describe loads from workers and building materials on an unfinished structure, for example when builders stack bundles of plywood or gypsum board on truss assemblies for temporary storage. Construction loads should be placed only on fully braced or sheathed structures. Use extreme caution when placing construction loads and only stack reasonable amounts of materials. Failure to follow these recommendations could lead to property damage and/or bodily injury. Trusses that are overstressed due to excessive construction loading will usually show excessive sagging, or in more severe cases, may show broken web or chord members or web members that have pulled out of their connector plated joints.



### Construction Loading **DOs** and **DON'Ts**

**DO** stack a reasonable amount of material that will not overload the trusses. The following chart and graphic represents a reasonable amount:

Maximum Stack Depth (h)	
Gypsum Board	= 12"
Plywood or OSB	= 16"
Asphalt Shingles	= 2 bundles
Concrete Block	= 8"

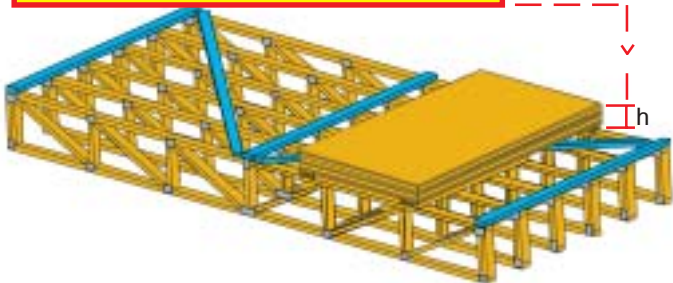

**DO** distribute loads over as many trusses as possible. Position sheets flat with the longest edge perpendicular to the trusses as shown above.



**DO** stack materials near locations of solid support.

**DON'T** stack materials on unbraced trusses.

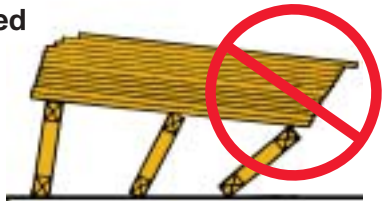

**DON'T** stack materials midway between supports.

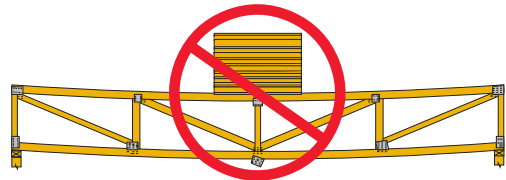
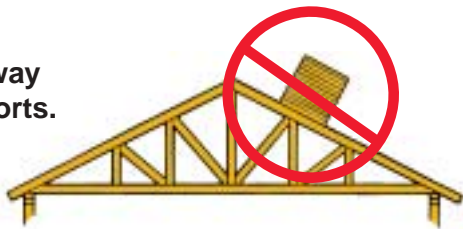

**DON'T** stack materials so that they overload single or small groups of trusses. Don't allow the stack to lean against walls.

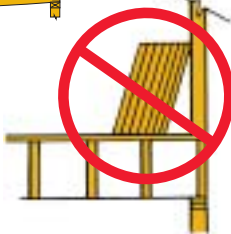

**DO** leave construction materials on lifting equipment until installation, if possible.



**DO** stack materials along outside supports or directly over inside supports of properly braced structures.

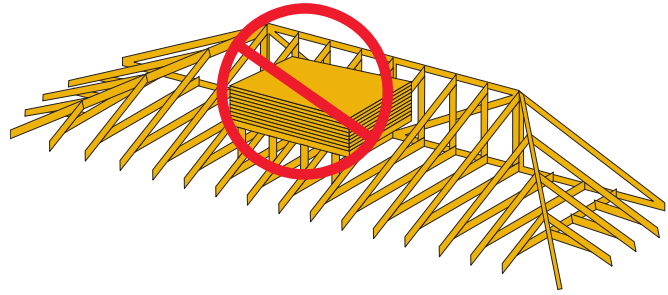
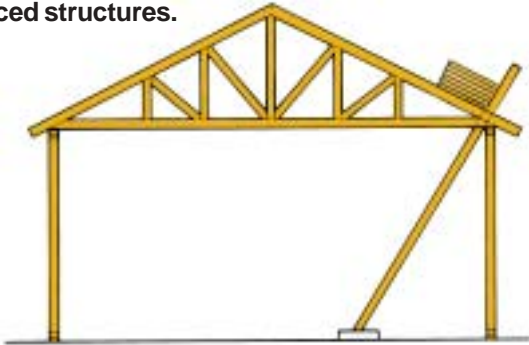

**DON'T** stack materials at locations that will produce instability, such as on cantilevers or near truss-to-girder connections.

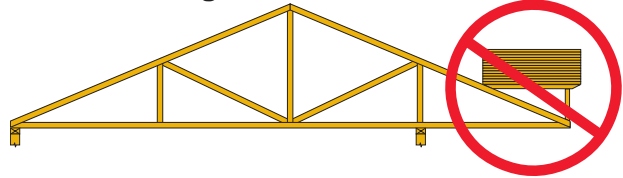

**DON'T** drop loads on trusses. The impact can damage the trusses even if the load is small.

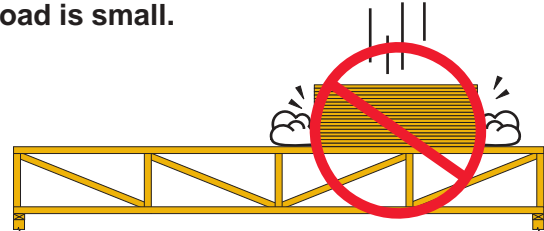

Trusses have **NO CAPACITY** to carry load **UNLESS** they're **PROPERLY BRACED** or **SHEATHED**. Make sure that the truss assembly is properly braced according to the guidelines in WTCA's **TTB—Always Diagonally Brace for Safety** and the **Job Site Warning Poster**.

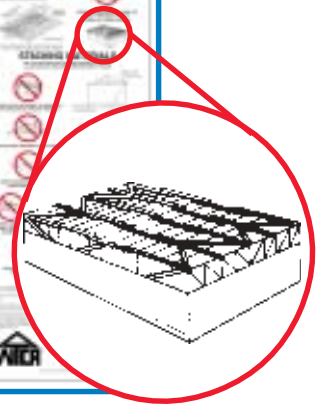

## Wood Truss Council of America

One WTCA Center  
6300 Enterprise Lane • Madison, WI 53719  
608/274-4849 • 608/274-3329 (fax)  
www.woodtruss.com • wtca@woodtruss.com

## Truss Technology IN BUILDING

An informational series designed to address the issues and questions faced by professionals in the building construction process.

Copyright © 2002 Wood Truss Council of America, Inc.

Reproduction of this document, in any form, is prohibited without written permission from WTCA. This document should appear in more than one color.

Front photo courtesy of Chambers Truss